

New Dwelling



A building plot in Balderton Village Conservation Area was purchased with planning permission for a three bedroom detached property. The brief was to maximise the plot and provide a better dwelling. A four/five double bedroom dwelling was commissioned with detached garaging.

Planning Drawing



With a fixed design in mind the planning drawings were produced for submission to the Local Authority Planning Department. (It is usual to allow upto 8 weeks for a decision from the local planning authority.) For more information on the planning system visit www.planningportal.gov.uk

Production Drawing (Sample)

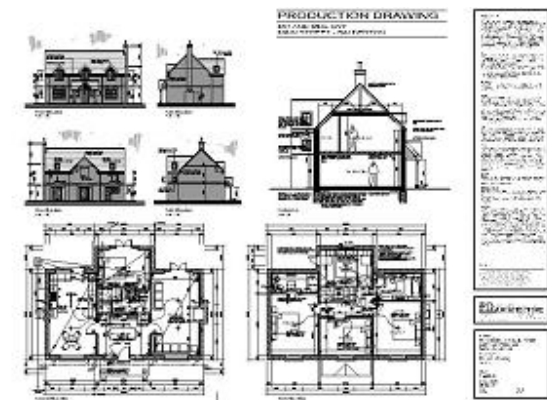

The production drawings were produced for tender and construction purposes and it is essential that these are detailed enough to;

- Discharge any conditions imposed by the planning department
- Adequate technical content to satisfy the requirements of Building Control to gain a Building Regulation Approval (on smaller projects works can be carried out under a building notice rather than a full plans submission)
- Obtain quotations from builders that can be reasonably relied upon (ambiguous drawings lead to difficulties on site and potentially large additional sums of extra work being required)
- Practically be able to be constructed and set out on site in accordance with the relevant requirements